

Lone Wolf

Normally open proportional solenoid valve

FEATURES

- 2-way normally open
- Achieves rapid, stable performance
- Enhances system control and patient comfort
- Maintains ideal flow through normally open valve with thermal compensation
- Extremely reliable
- RoHS compliant



MEDIA COMPATIBILITY

Air, nitrogen, oxygen & others

WETTED MATERIALS

Body:
360 HO₂ brass

Stem base:
430 FR stainless steel and brass 360 HT

All others:
FKM, 430 FR stainless steel, 300 series stainless steel

ELECTRICAL

Power 0.5, 1.0 or 2.0 W
Voltage 5.5 to 29 V_{DC}
Electrical terminal PC mount, 18" wire leads

PHYSICAL PROPERTIES

Operating environment	0 to 50 °C
Storage temperature	-40 to 70 °C
Length	45.3 mm (1.785 in)
Width	16.5 mm (0.625 in)
Height	17 mm (0.67 in)
Porting	manifold mount with 43 µm screens, 1/8" barbs, 5/64" barbs
Weight	63 g (2.2 oz)
Internal volume	0.508 cm ³ (0.031 in ³)
Filtration (recommended)	40 µm
Lubrication	None required

Lone Wolf

Normally open proportional solenoid valve

PERFORMANCE CHARACTERISTICS

Part no.	Pressure	Vacuum	Orifice sizes	Leak rate ¹	Response
LW1...	0..10 psi	0...20 "Hg (0...10 psi)	0.024" (0.610 mm)	Internal: 0.2 sccm (bubble tight)	<30 msec cycling (2 W)
LW2...	0...20 psi		0.030" (0.762 mm)		
LW3...	0...25 psi		0.036" (0.914 mm)	External: 0.016 sccm	

FLOW CURVES²

Typical air flow,
13.5 V coil @ 5 psid

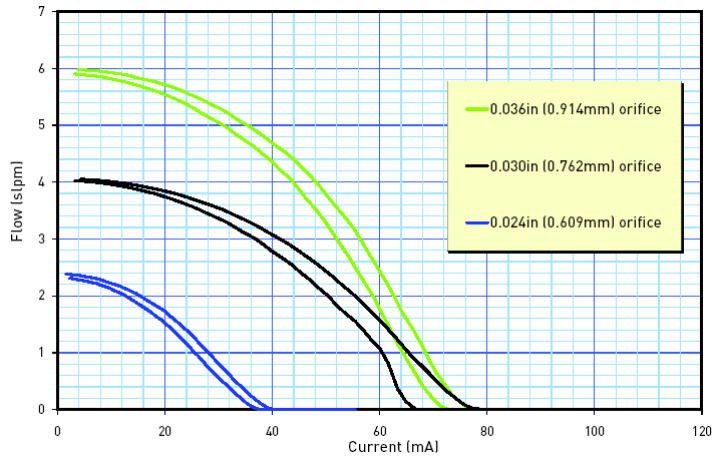

Pressure vs flow

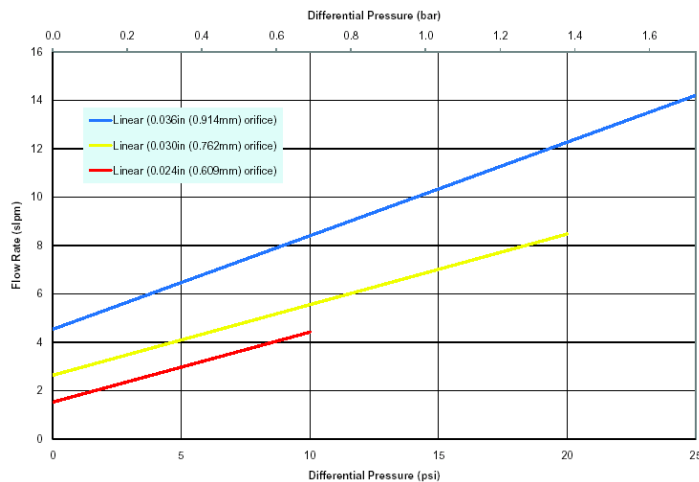

Notes:

- ¹ sccm denotes Standard Cubic Centimeters per Minute. It is a unit for the flow rate at standard conditions of temperature and pressure. 1000 sccm = 1 slpm.
- ² slpm denotes Standard Liters per Minute. It is a unit for the flow rate at standard conditions of temperature and pressure. 1 slpm = 1000 sccm.

Lone Wolf

Normally open proportional solenoid valve

ELECTRICAL REQUIREMENTS

Min. available voltage	0.024" orifice		0.030" orifice		0.036" orifice	
	Nominal coil resistance @ 20 °C	Input current for full shut off	Nominal coil resistance @ 20 °C	Input current for full shut off	Nominal coil resistance @ 20 °C	Input current for full shut off
5.5 V	47 Ω	92 mA	23 Ω	177 mA	11 Ω	335 mA
8.0 V	68 Ω	76 mA	47 Ω	127 mA	23 Ω	233 mA
11.5 V	136 Ω	55 mA	68 Ω	105 mA	47 Ω	168 mA
13.5 V	274 Ω	40 mA	136 Ω	76 mA	68 Ω	138 mA
20.0 V	547 Ω	28 mA	274 Ω	55 mA	136 Ω	100 mA
29.0 V	1094 Ω	20 mA	547 Ω	40 mA	274 Ω	73 mA

OUTLINE DRAWING

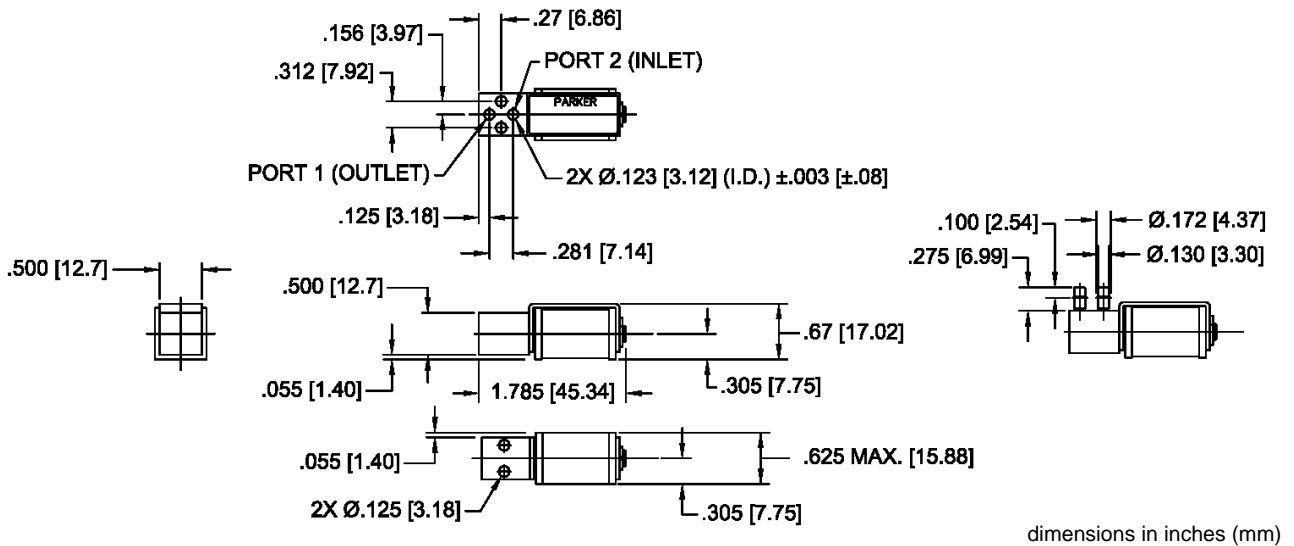

Lone Wolf

Normally open proportional solenoid valve

ELECTRICAL INTERFACE OPTIONS

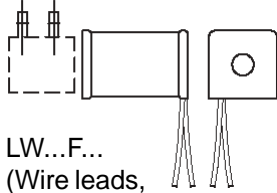

LW...F...
(Wire leads,
no terminals)

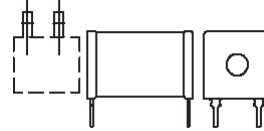

LW...P...
(PC mount, 4 pins)

PNEUMATIC INTERFACE OPTIONS

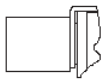

LW...0
(No barbs,
face seal to manifold)

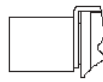

LW...1
(No barbs,
face seal to manifold
with screen)

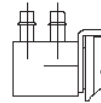

LW...8
(0.125" barbs, 1/8" I.D.
tubing, 1/4" O.D. max)

ORDERING INFORMATION

Options	Standard	Model no.				Material		Elastomer		Coil selection		Electrical interface		Pneumatic interface	
			Max. pressure	Orifice	Coil Wattage										
	LW	1	10 psi	0.024" (0.610 mm)	0.5 W	B	Brass	V	FKM	A	5.5 V	F	wire leads, 18-19"	0	manifold mount
		2	20 psi	0.030" (0.762 mm)	1 W					B	8 V				
		3	25 psi	0.036" (0.914 mm)	2 W					C	11.5 V	P	PC board mount, 4 PC pins	1	manifold mount with screens*
										D	13.5 V				
										E	20 V			8	1/8" barbs
										F	29 V				
														* this option will affect price	
Example:	LW	1				B		V		A		F		8	

Note: Not all combinations might be available. Please contact First Sensor for further information.

First Sensor reserves the right to make changes to any products herein. First Sensor does not assume any liability arising out of the application or use of any product or circuit described herein, neither does it convey any license under its patent rights nor the rights of others.