



TX Series

8 mm switching solenoid valves

FEATURES

- 2-way or 3-way, 2 position (NO, NC & Distributor)
- Compact size, only 8 mm in width
- Meets pressure requirements including 6, 30 & 100 psi
- Excellent leakage specification for over 25 million cycles
- Ensures high reliability with its single piece body design
- Barbed pressure ports allow for direct tubing or manifold assemblies
- RoHS compliant
- PRO services



MEDIA COMPATIBILITY

Non-reactive gases

WETTED MATERIALS

Bobbin/Body	PBT (polybutylene terephthalate)
Pole and plunger	430 FR series stainless steel
Seal (options)	FKM, EPDM, silicone
Other	302 series stainless steel

ELECTRICAL

Power		
TX...P006... (6 psi)		0.5 W
all other (30 psi, 100 psi)		1.0 W
Voltage	3, 5, 12, 24 V _{DC}	
Electrical connections	PC pins, 4 mm centers	

PHYSICAL PROPERTIES

Operating environment	0 to 50 °C
Storage temperature	-40 to 70 °C
Length	24 mm (0.92 in)
Width	7.9 mm (0.31 in)
Height	9.5 mm (0.375 in)
Spacing	8 mm (centerline)
Porting	Universal barbs for 1/16 in I.D. tubing (1/32 in wall max.); manifold mount with X-seal
Weight	4.5 g (0.16 oz)
Internal volume	0.092 cm ³ (0.0056 in ³)



TX Series

8 mm switching solenoid valves

PERFORMANCE CHARACTERISTICS

Part no.	Pressure ⁴	Minimum flow	Orifice sizes/ Equivalent C_v ¹	Leak rate ²	Response
TX...P006...	0...6 psid	4 lpm @ 6 psid	0.045 in (1.143 mm)/ 0.018 C_v	≤ 0.16 sccm (FKM, EPDM), ≤ 0.016 sccm (silicone)	<20 ms cycling
TX...P030...	0...30 psid	6 lpm @ 30 psid	0.030 in (0.76 mm)/ 0.010 C_v	≤ 0.016 sccm	
TX...P100...	0...100 psid	9 lpm @ 100 psid	0.020 in (0.51 mm)/ 0.005 C_v	≤ 0.2 sccm	

FLOW CURVES (typ. air flow @ 24 °C)³

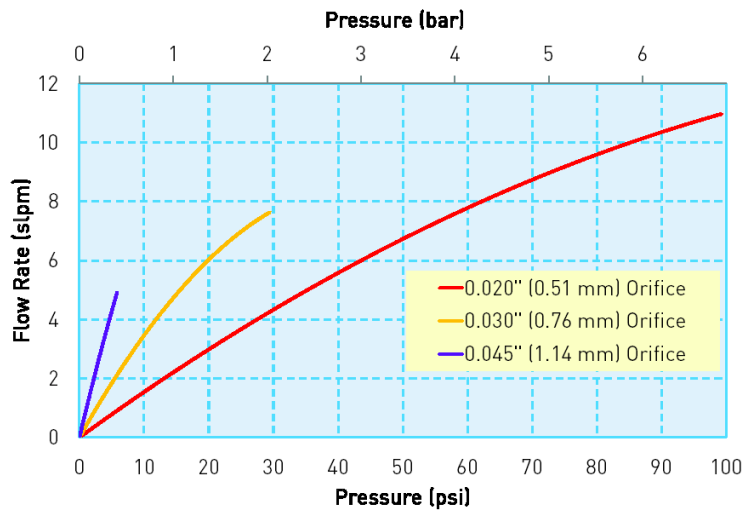

CONNECTION DIAGRAM

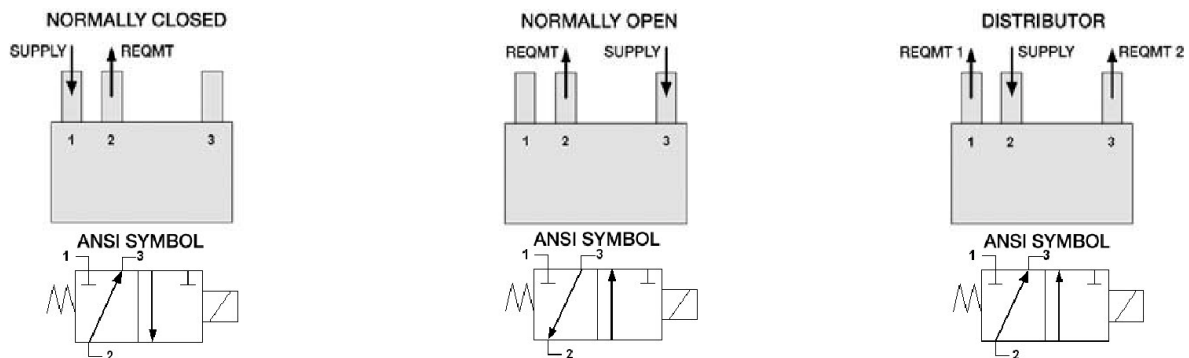

Notes:

- The C_v value is the volume flow in US gallons/min under specific flow conditions and describes the relative flow capacity of a valve. The equivalent european measure is the k_v value expressed in m^3/h ($k_v = 0.86 C_v$).
- sccm denotes Standard Cubic Centimeters per Minute. It is a unit for the flow rate at standard conditions of temperature and pressure. 1000 sccm = 1 slpm.
- slpm denotes Standard Liters per Minute. It is a unit for the flow rate at standard conditions of temperature and pressure. 1 slpm = 1000 sccm.
- Proof pressure is 200 psig (13.7 bar)



TX Series

8 mm switching solenoid valves

ELECTRICAL CONNECTION

Short pin

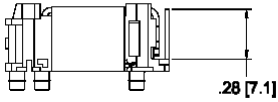

Long pin

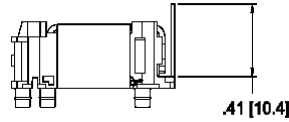

dimensions in inches (mm)

Electrical terminals compatible with Molex 51065 series connector or equivalent.

OUTLINE DRAWING

Side view

3-WAY UNIVERSAL, NORMALLY OPEN PORT
2-WAY NORMALLY CLOSED, BLOCKED PORT (NOT USED)

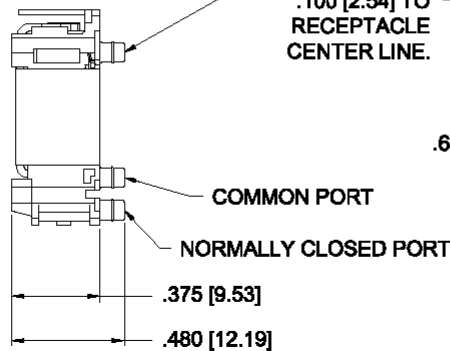

Bottom view

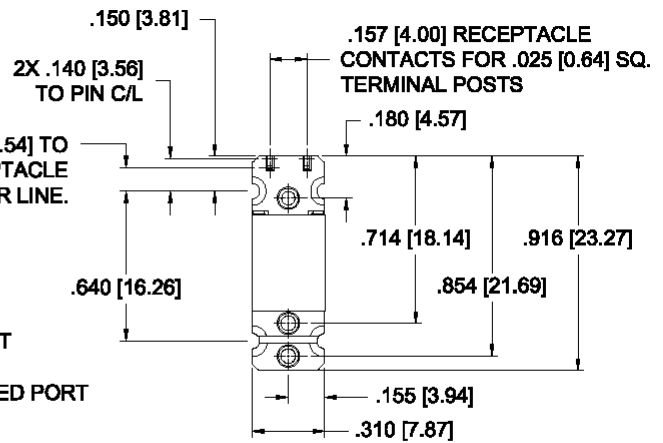

dimensions in inches (mm)

Manifold mount diagram

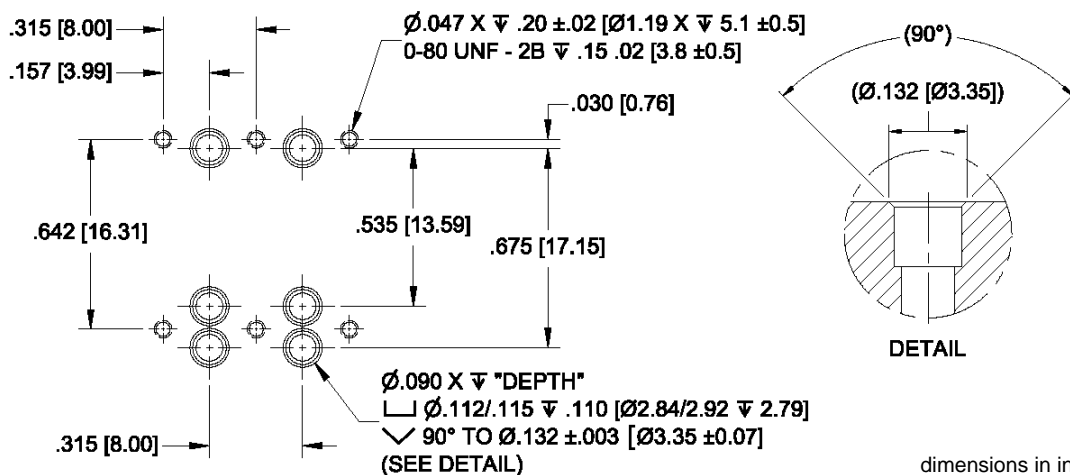

dimensions in inches (mm)



TX Series

8 mm switching solenoid valves

ORDERING INFORMATION

Options	Series	Ways		Pressure / Function		Elastomer		Voltage		Electical		Accessories	
	TX	3	3 way	P006L	6 psi, Universal	V	Viton (FKM)	03	3 V _{DC}	S	Short pins	B	Screws and gasket
		2*	2 way	P030L	30 psi, Universal	S	Silicone (6 psi only)	05	5 V _{DC}	L	Long pins	N	No accessories
				P100C	100 psi, NC	E	EPDM (6 psi only)	12	12 V _{DC}				
								24	24 V _{DC}				
* only with FKM Port 3 internally blocked.													
Example:	TX	3		P006L		V		05		S		B	

Note: Not all combinations might be available. Please contact First Sensor.

Accessories (please order separately using the following order numbers)

Order No.	Description
ZK071248	Clear transparent polyurethane tubing, ID 1/16 in (1.6 mm), OD 1/8 in (3.2 mm)
X-RETAINING CLIP	Solder clip for mounting
X-CONNECTOR	12 in (30.5 cm) leads with connector

PRO services:

- Extended warranty period of 2 years
- Advanced logistics models for supply inventory and short delivery times
- Technical support through application engineers on the phone or at your site
- Fastest possible technical response for design and QA engineers
- ... plus other services on request

First Sensor reserves the right to make changes to any products herein. First Sensor does not assume any liability arising out of the application or use of any product or circuit described herein, neither does it convey any license under its patent rights nor the rights of others.